

ROKSAN



COMPACT
disc
DIGITAL AUDIO

ROKSAN AUDIO LIMITED
6 NORTHFIELD INDUSTRIAL ESTATE
BERESFORD AVENUE ALPERTON
MIDDLESEX HA0 1NW ENGLAND
TEL. +44 (0)20 8900 6801 / 6802
FAX. +44 (0)20 89000734
www.roksan.co.uk
Email info@roksan.co.uk

PRINTED IN ENGLAND

LASER SAFETY

This unit employs a laser. Only qualified persons should remove the cover or attempt to service this unit due to the risk of eye injury.

Laser Diode Properties

Materials: Ga-Al-As
Wavelength: 755-815 nm (25°C)
Laser Output: Continuous Wave max. 0.7mW

CAUTION INVISIBLE LASER RADIATION WHEN OPEN AND INTERLOCKS DEFEATED. AVOID EXPOSURE TO BEAM.
VORSICHT! UNSICHTBARE LASERTRABLUNG TRITT AUS. WENN DECKEL GEÖFFNET UND WENN SICHERHEITSVERRIEGELLUNG ÜBERBRÜCKT IST. NICHT DEM STRAHL AUSSETZEN!
VARNING OSYNUG LASERSTRÄLNING NÄR DENNA DEL ÄR ÖPPNAD OCH SPÄRR ÄR URKOPPLAD. STRÄLEN ÄR FARLIG.
ADVARSEL USYNLIG LASERSTRÄLING VED ÅBNING, NÄR SIKKERHEDSAFBRYDERE ER UDE AF FUNKTION. UNDDGA UDSÆTELSE FOR STRÄLING.
VARO! AVATTAESSA JA SUOJALUKITUS OHITETTAESSA OLET ALTTINA NÄKYMÄTTÖMÄLLE LASERSÄTEIL YLLE. ÄLÄ KATSO SÄTEESEEN.

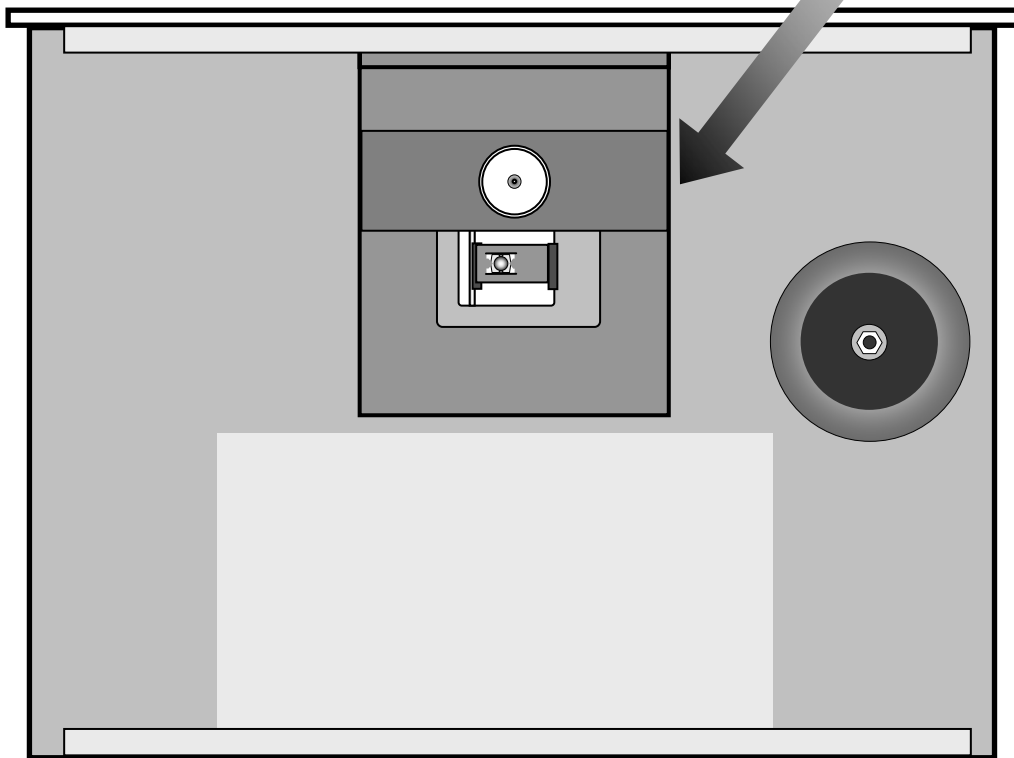

**CLASS 1 LASER PRODUCT
LUOKAN 1 LASERLAITE
KLASS 1 LASERAPPARAT**

Congratulations on your purchase of the ROKSAN Kandy **K2** CD Player. This CD Player is designed and manufactured to the highest specification and rigorously tested to reward you with many years of listening pleasure.

Your Kandy **K2** CD Player is at the heart of your hi-fi system. Its correct installation, set-up and operation will have a profound influence on the sonic performance of the entire hi-fi installation.

Please read the contents of this manual thoroughly. It will help you to understand your hi-fi equipment better and enhance your listening pleasure.

This manual is divided into the following sections:

- Safety Instructions (Accompanying card)
- Safety Certification
- Introduction
- Cautions
- Installation
- Setup
- Operation
- Troubleshooting
- Guarantee
- Specifications
- Notes

UNPACKING

Included in the packing of your Kandy **K2** CD Player you will find:

- One mains lead fitted with the correct mains power plug for your country
- One Roksan Programmable Learning Remote Handset **RMX-108** and AAA batteries (x4)
- One information pack and warranty card

After removing these items please retain **all** packing materials. Correct packing is necessary for safe transportation of your Kandy **K2** CD Player.

MAINTENANCE

After disconnecting the Kandy **K2** CD Player from the mains supply, the cabinet and front panel may be cleaned with a lightly dampened soft cloth or chamois leather. **Avoid using abrasives or solvents.**

EU DIRECTIVES

This product is designed to comply with the legal provisions of EU Directives 89/3336/EC and 72/23/EC. The standards which have been applied are those which were in force at the time of the introduction of this product.

This product bears the CE mark.



This product is compliant to EN 60065.

This product must be earthed. Please ensure that other equipment connected to it is earthed according to the manufacturer's instructions.

AC MAINS SUPPLY

Your Kandy **K2** CD Player is set to operate from a fixed supply voltage which is marked on a label next to the mains input plug. Before connecting the mains lead please check that your mains supply corresponds to this label as below:

230V Products	Voltage Range: 220V – 240V
115V Products	Voltage Range: 110V – 120V
100V Products	Voltage Range: 90V – 110V

The mains lead supplied with this product has an IEC mains socket which plugs into the IEC connector on the unit's rear panel. The other end is normally attached to the appropriate mains plug for your country. In the UK this is the standard UK13A plug.

This plug should ordinarily not be removed from the lead. If you *do* remove it, please dispose of it safely so that it cannot be plugged into a mains socket whilst in a potentially dangerous condition. We suggest that you obtain from your dealer a complete replacement lead.

Should you move to another area where either the mains voltage or the mains plugs are different from those as supplied with your CD Player, please contact the appointed ROKSAN distributor for assistance.

Please observe correct mains polarity at all times.

The CD Player mains fuses are located on the rear panel next to the IEC mains connector. They must only be replaced by the fuse of the type and rating as described on the fuse rating label on the rear panel of the unit.

This product requires connection to earth (ground). The earth wire (in the UK this is colour coded green/yellow) of the mains cable supplied with your CD Player must be connected to a suitable earthing point established for this purpose by your electricity supply company. If you are in any doubt, consult a qualified electrician.

If the equipment is likely to be unattended for some time, unplug it from the mains supply.

GENERAL CAUTIONS**FCC WARNING**

This equipment may generate or use Radio Frequency energy. The user may lose the right to operate this equipment if unauthorised modifications are made.

INTERFERENCE

Properly installed, this unit should not cause harmful interference to radio communications, There is, however, no guarantee that such interference will not occur in a specific installation. If interference arises (which you can determine by switching the unit off and on) you could try to remedy matters by the following:

- Re-orient or re-locate the receiving antenna
- Increase the distance between the CD Player and receiver
- Connect the unit to a different mains circuit from that of the receiver
- Consult your ROKSAN appointed dealer or an experienced Radio/TV technician for help and advice

LOCATION

Your Kandy **K2** CD Player should be located in a well ventilated area and kept away from sources of heat, dust and humidity and from direct sunlight.

The CD Player may be positioned either as a free standing unit or alongside another audio/video product. Never place the CD Player on carpet or any surface likely to hinder normal ventilation.

Never allow liquids or other objects to fall into the unit.

This unit contains no user serviceable parts. **Do Not remove any panels or attempt to service it yourself.** Unauthorised servicing will void the warranty.

ROKSAN Kandy K2 CD Player- Front Panel View

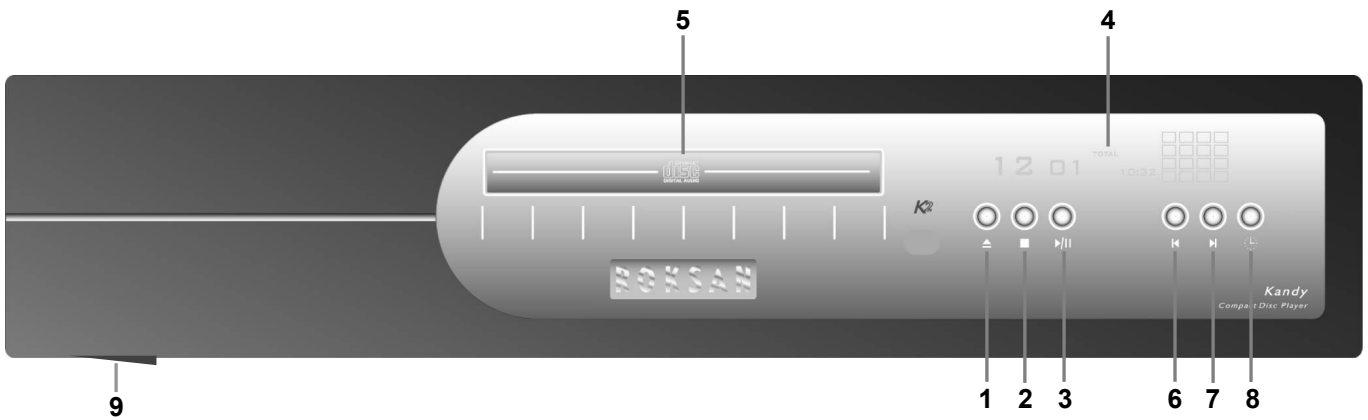

- 1 Open / Close Button
- 2 Stop Button
- 3 Play / Pause Button
- 4 Fluorescent Display (*behind 'mirror' display*)
- 5 CD Disc Tray
- 6 Track Back Button
- 7 Track Forward Button
- 8 Display 'Time' Button
- 9 AC Mains Switch

NOTE: There is a peel off protective film on the mirror display.

ROKSAN Kandy K2 CD Player - Rear Panel View

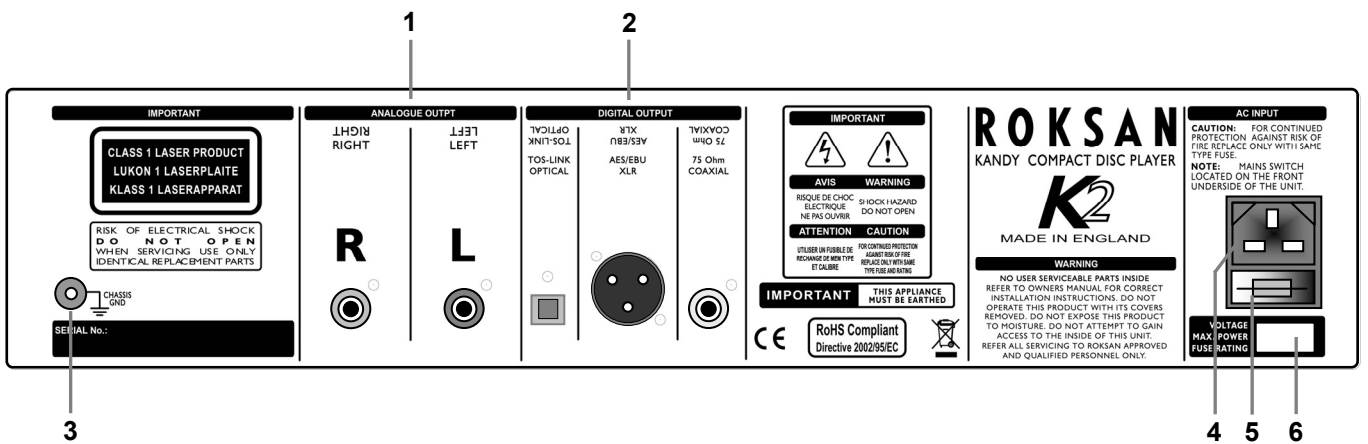

- 1 Analogue Output (*Left & Right*)
- 2 Digital Outputs (*Optical: Toslink; Balanced: AES/EBU; Coaxial: RCA*)
- 3 Chassis Grounding Terminal (*optional grounding*)
- 4 IEC Mains Inlet Socket
- 5 AC Mains Fuseholder
- 6 Voltage & Fuse Rating Label

CONNECTING MAINS POWER

Please refer to the front & rear panel view on page 4. The moulded IEC connector of the supplied mains lead should be plugged into the socket (4) on the rear of the unit first and then plugged into the mains supply. The Mains power switch (9) is on the front underside of the CD Player. This switch can be left on; if however the CD Player is likely to be unattended for a long period, switch it off and unplug the mains lead from the wall.

SIGNAL CONNECTIONS

ANALOGUE OUTPUT:

The Analogue Outputs (1) use Gold plated RCA Phono sockets and should be connected to the CD or LINE input of your Preamplifier or Amplifier. Standard convention – **Right Channel – Red; Left Channel – Black or White.**

DIGITAL OUTPUT:

The Digital Outputs (2) utilise; Gold plated RCA Phono socket for Coaxial SPDIF output, Toslink for Optical output and XLR for Balanced AES/EBU output. Any of these could be connected to a corresponding input of an amplifier with a digital input, or to an outboard Digital to Analogue converter (DAC).

IMPORTANT NOTE: For optimum performance it is recommended to use high quality inter-connect cables such as ROKSAN **HDC-02A** High Definition Analogue Cable and **HDC-01D** High Definition Coaxial Digital Cable.

OPERATION

K a n d y **K2** Integrated CD Player

Please refer to the rear panel view on page 4.

SWITCHING ON

The Mains power switch (9) is located on the front underside of the CD Player. This switch can be left ON for normal operation. If unattended for a long period (*Going on a short break, holidays etc.*) the Mains power should be switched OFF and the power cord disconnected from the mains power input.

When switched ON, the **K2** logo in the 'mirror' display will glow red and the CD Player FL Display will illuminate.

USING THE CONTROLS

Please refer to the front panel view on page 4.

LOADING A DISC

Press the Open/Close Button (1) once to open the disc loading tray (Display will indicate: **open**). Carefully load a disc into the tray recess with the label side up. Press the button again to close the tray.

Note: Never load a disc until the drawer has opened fully, or try to close the drawer until you are sure that the disc is properly seated in the holder recess.

Warped discs should *never* be played.

The drawer should only be opened using the front panel control. Under no circumstances should you attempt to open manually.

If a disc is not inserted or if the disc is damaged or inserted upside down, the CD player will remain inoperative (Display will indicate: **no disc**).

When a disc has been loaded, your Kandy CD Player will briefly spin the disc while it studies the data encoded on it. The disc will then stop and the display will indicate the number of tracks on the disc and the total play time.

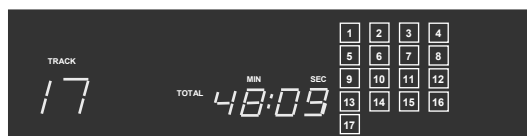

To commence playing a disc, press Play/Pause Button **(3)** once. The disc will play from the beginning. Press the Play/Pause button **(3)** a second time to pause the disc whilst it is playing. Pressing the button again will resume playback from the point at which Pause mode was entered. In Pause mode, the disc continues spinning and the laser will still be operational but locked. Please keep the CD player in Pause mode no longer than strictly necessary.

SELECTING A TRACK

Press the Track Forward Button **(7)** to go to the next track on the disc. Pressing the Track Back Button **(6)** will take you to the previous track.

***** When the disc is playing, press the Track Back Button once to take you to the beginning of the current track and a second time to take you to the start of the previous track.

In Play mode press the Track Forward Button **(7)** to take you forward to the start of the next track.

Once the procedure is complete the disc will commence playing from the selected track.

When a disc is first loaded, you can use these buttons to select your desired track. Having done so, press the Play/Pause Button and your disc will commence playing from the selected track.

You may select a track when Pause is engaged. In this case, the disc will revert to Pause after the procedure is complete and you will have to press Play/Pause Button to continue playing the disc.

DISPLAY

Pressing the Time Button **(8)** on the front panel repeatedly will cycle the display through the following modes:

Normal

Display

Indicates track No. and how long it has been playing.

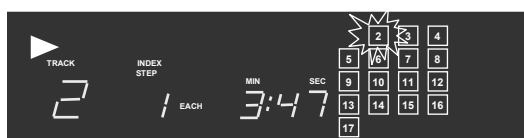

First Press

Display

Indicates track No. and remaining time on the track.

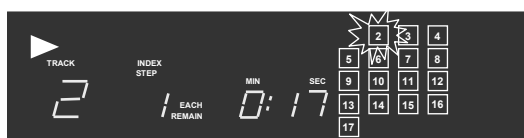

Second Press

Display

Indicates number of tracks and remaining time on the disc.

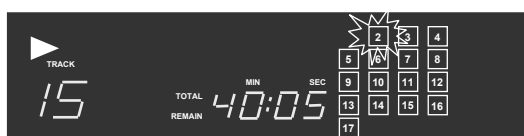

REMOTE HANDSET

The Kandy **K2** CD Player is supplied with Roksan's programmable, learning remote handset (**RMX-108**) and four AAA size 1.5V batteries.

Carefully remove the battery compartment cover and insert the supplied batteries in place observing **polarity**. Replace the cover. The handset is now ready for use.

The handset duplicates the front panel controls (with the exception of 'Time') and includes several extra features.

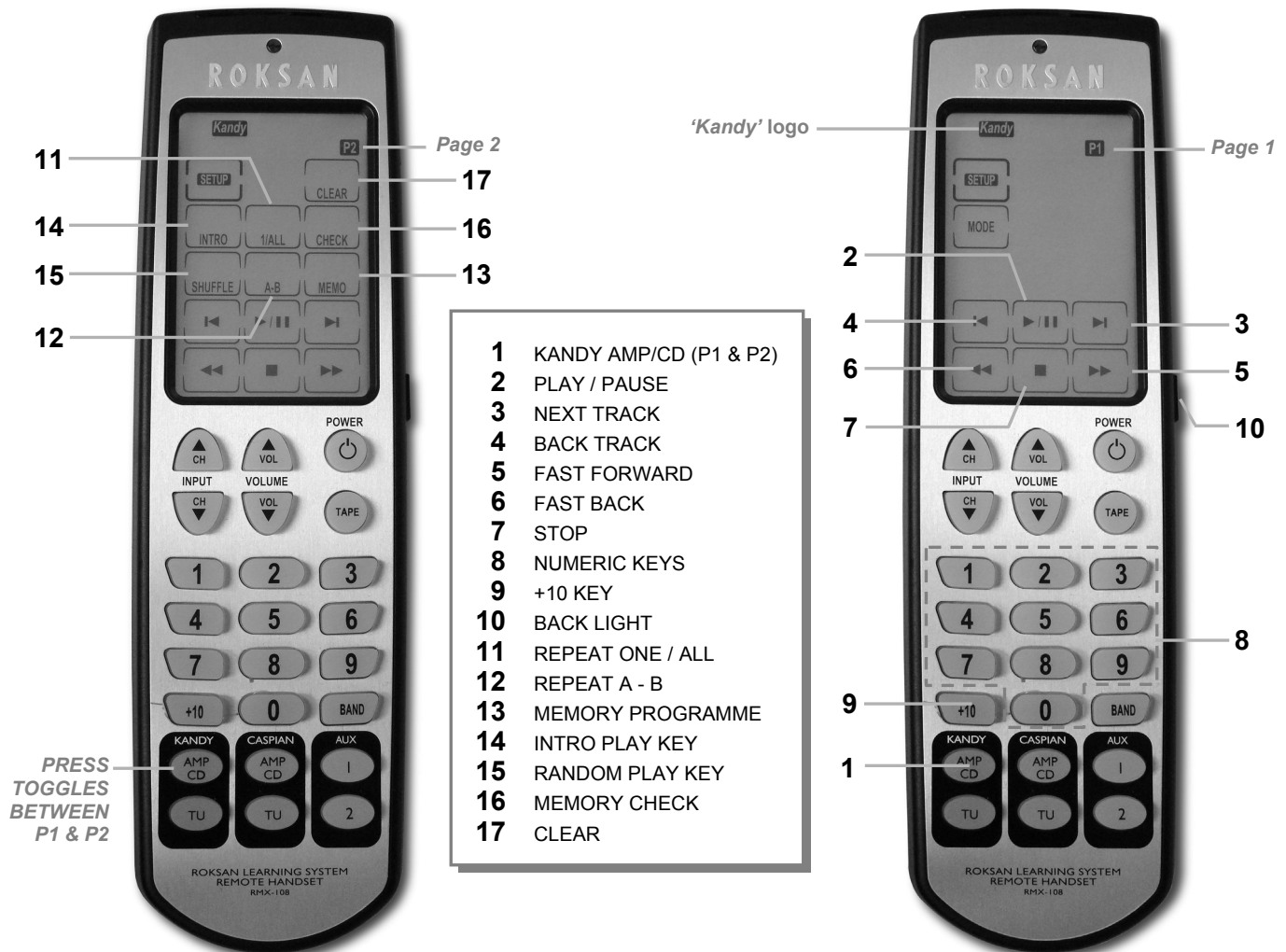

NOTE:

The LCD display & the hand set will turn on as soon as the batteries are inserted. If the handset is left untouched for 90 seconds, it will automatically turn off the LCD to save battery life. The handset is equipped with a motion sensor and thus will 'wake up' as soon as it is picked up.

The Back Light will only come on when the back light button is pressed and will stay on during operation. Back light will turn off automatically after 10 seconds if none of the buttons are pressed.

1 The KANDY 'AMP/CD' Button (**1**) selects Kandy CD and Integrated devices (**'Kandy' logo on LCD**). **This button toggles between Page1 & Page2 of the LCD display for the CD remote functions.**

10 The BACK LIGHT Button (**10**) turns on the handset buttons and LCD display illumination.

REPEAT

There are three repeat functions available on your CD player:

1. To repeat all tracks on the disc press Repeat Button **(11)** 1/ALL. The display will show 'REPEAT (ALL)'.
2. To repeat one track press Repeat Button **(11)** 1/ALL twice. The display will show 'REPEAT (ONE)'.
3. To repeat a section:
 - Press PLAY to start playing the disc
 - Go to the track at the start of the section
 - Designate the beginning track of the section by pressing Repeat Button **(12)** A-B. The display will show 'REPEAT (A)'
 - Go to the track at the end of the section
 - Designate the end track of the section by pressing Repeat Button **(12)** A-B. The display will show 'REPEAT (B)'

The section selected will play repeatedly until pressing Repeat Button **(12)** A-B again to stop section repeat.

MEMORY

Pressing the Memory Button **(13)** lets you select specific tracks and play them in any order. **Programming must be performed in STOP mode.**

To programme a sequence:

- 1 Press Memory Button **(13)** on the handset.

Display

The word **MEMORY** lights and the display flashes track **1** and step **1** ready for programming.



- 2 Select a track from the handset, using the Next Track, Back Track Buttons **(3, 4)**, or via the Numeric Keys **(8)**. (For example track **3**)

Display

Shows **3** the selected track and step **2** ready for the next track to be programmed.



- 3 Select the next desired track. (For example track **9**)

Display

Shows **9** the selected track and step **3** ready for the next track to be programmed.



- 4 When you have assembled your programme, press the Play Button to start Programme Play.
 - You can select a track more than once to be played in the programme.
 - You can press stop and the programme will still remain.
 - You can check and change programmed tracks in stop mode by pressing the Check Button **(16)** to march through the programme steps and use the Clear Button **(17)** to delete a track and then select a new track in its place if you wish.

TO CANCEL A PROGRAMME

Press the Clear Button **(17)** in stop mode and hold for **3 seconds** to clear all programmed tracks.

If you suspect your ROKSAN Kandy CD Player is not operating properly, first check all the connections carefully. Pay particular attention to input and output connections. Phono plugs should be fully inserted- a frequent cause of problems is that Phono plug surrounds do not make proper contact. Below are some commonly encountered problems with suggestions for possible cure. The list is not exhaustive: If you have any unresolved problems, please consult ROKSAN or your appointed ROKSAN dealer or distributor.

SYMPTOM	LIKELY CAUSE	SUGGESTED REMEDY
The disc tray will not close when a disc is inserted	Disc not placed properly in tray Disc is warped	Re-place disc properly Discard disc
Disc inserts, display does not show the number of tracks and playing time	Disc inserted upside down Disc is dirty or scratched Condensation on the laser lens Dirt on the laser lens	Re-insert disc label side up Clean disc, discard scratched disc Let CD player warm up and dry out lens Refer to appointed dealer or service centre DO NOT use CD lens cleaners
Skipping & mistracking	Excessive vibration Disc is dirty or scratched	Ensure player is stable and vibration-free Clean disc, discard scratched disc
Programme play inoperative	Programming accidentally erased	Re-programme memory
Excessive hum	Connection loose, cable faulty	Re-connect plugs, change interconnect
One channel inoperative	Interconnect or amplifier faulty	Change lead, try another line input on amp
Remote handset operation erratic or not working	Batteries weak or wrongly inserted Handset signal path is obstructed Handset transmission angle too wide Room lighting/sunlight excessive	Replace batteries, observe polarity Remove obstruction, move handset Operate handset in front of CD Player Darken room

GUARANTEE

K a n d y **K2** *Integrated Amplifier*

There are no user-serviceable parts inside your Kandy CD Player. If a fault should develop; refer all servicing to your appointed ROKSAN retailer, distributor or ROKSAN approved service agent.

Your ROKSAN Kandy CD Player is guaranteed against any defect in materials and workmanship for a period of **two years** from the date of purchase.

This guarantee only becomes effective if the warranty card is validated by the ROKSAN retailer from whom the equipment was purchased and returned to ROKSAN within **28 days** of purchase.

This guarantee excludes:

1. Damage caused due to accident, misuse, neglect and incorrect installation, adjustment or repair.
2. Liability for damage or loss during transit from the retailer or purchaser to ROKSAN or its authorised distributor for the purposes of repair or inspection.

Carriage costs to ROKSAN shall be borne by the consignor.

All claims under this guarantee must be made through an authorised ROKSAN retailer.

If equipment returned for repair to ROKSAN is found on inspection to comply with the product specification ROKSAN reserves the right to make a charge for examination and return carriage.

Unauthorised servicing will void this guarantee.

Operating System	CD digital audio system (CD, CD-R, CD-RW)
Frequency Response	20Hz – 20kHz \pm 0.2dB
Harmonic Distortion	< 0.002% @ 0dB, 1kHz < 0.006% @ -30dB, 1kHz < 0.002% @ 0dB, 20Hz < 0.008% @ 0dB, 20kHz
Intermodulation Distortion	< 0.001% @ 0dB
S/N Ratio (IHF-A Wtd.)	105 dB
Wow & Flutter	Quartz precision
Channel Separation	110 dB @ 1kHz 100 dB @ 20kHz
Output Voltage	2.2Vrms
Digital Outputs	75 Ohm Coaxial, RCA 110 Ohm Balanced AES/EBU, XLR Optical, Toslink
D/A Conversion	PCM1798 Advance Segment, Audio-Stereo DAC
Resolution/Sampling	24 bits / 192 kHz
Oscillation	3 rd Overtone Oscillation
Crystal	Super precision, custom made
Jitter	<150 psec
Idle Pattern	<-112 dB
Stop band Rejection	<-95 dB
Power Supply	High performance low noise toroidal transformer 7 fully regulated power rails
Power Source	100V – 120V 50Hz / 60Hz 220V – 240V 50Hz / 60Hz
Power Consumption	< 15 W
Dimension	432 x 380 x 90 (W x D x H) mm 432 x 380 x 102 (including feet)
Weight	9Kg

NOTES

K a n d y **K2** *Integrated Amplifier*

Kandy CD Player K2

Purchase Date

ROKSAN Retailer

Serial Number:

Year

Month

Day

Name:

Location:

Please keep a record for future reference



K2

w w w . r o k s a n . c o . u k